

Beelitz-Waldresidenz | Unit 116

Living in a historical monument
 Dr. Herrmann-Straße 4e, 14547 Beelitz-Heilstätten

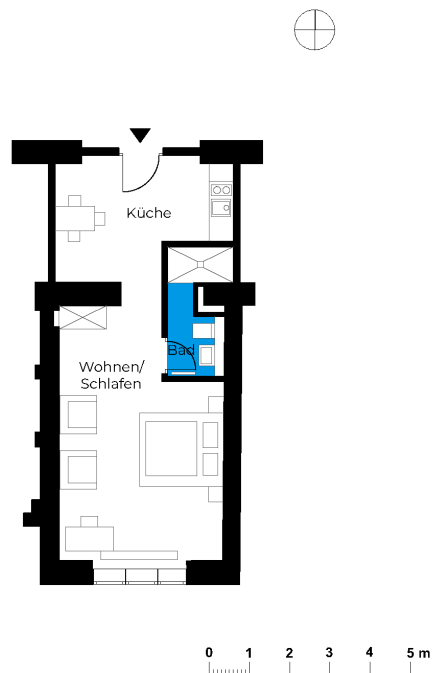

1 room first floor	m²
Bathroom	4.19
Kitchen	12.62
Living room	23.2
<hr/> Net living area	<hr/> 40.01
 Total living area	 40.01

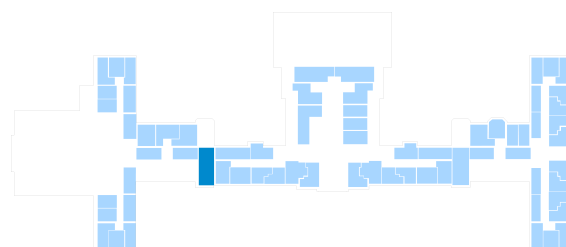

The image and plan material serves the tentative illustration of the project. Deviations in a later planning stage are explicitly reserved. Small variations concerning the areas are possible within a floor plan type. All dimensions are approximate. Due to technical requirements, partial areas can possibly be separated, and ceilings can be suspended.

The terraces and balconies are counted towards 50%.