

Bergfelde II | House A | Unit 8

Mittelstraße 4, 16562 Hohen Neuendorf

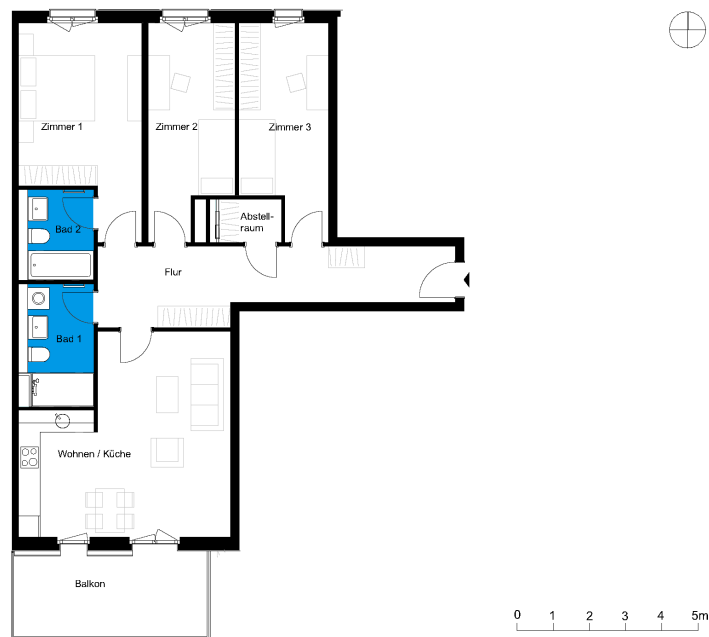

3 rooms second floor	m ²
Corridor	17.88
Bathroom 1	6.8
Bathroom 2	5.19
Eat-in kitchen	28.05
Storeroom	2.04
Room 1	17.23
Room 2	13.34
Room 3	12.96
Net living area	103.49
Balcony (50%)	4.77
Total living area	108.26

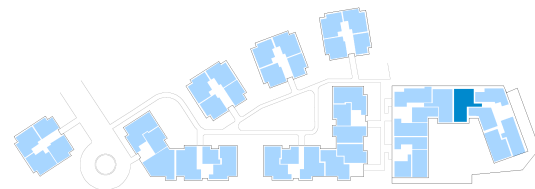

The image and plan material serves the tentative illustration of the project. Deviations in a later planning stage are explicitly reserved. Small variations concerning the areas are possible within a floor plan type. All dimensions are approximate. Due to technical requirements, partial areas can possibly be separated, and ceilings can be suspended.

The terraces and balconies are counted towards 50%.